

STEAMLOK ENGINEERING

SLVB - 76 Vacuum Breaker



**SLVB - 76 is an uniquely designed
Vacuum Breaker in Stainless Steel Construction.**

SIZE

Pipe Connection : 15NB
Air Connection : 6NB BSPT

PIPE CONNECTIONS

Screwed : BSP, BSPT, NPT

UNIQUE FEATURES

- Stainless steel construction
- Robust design
- Testing 100% on steam

DESIGN CONDITIONS

- Max. Allowable Pressure (PMA) - 49.6 Bar (g) @ Room Temp.
- Max. Allowable Temp (TMA) - 538° C
- Max. Operating Pressure (PMO) - 24.4 Bar (g) @ 538° C

CERTIFICATION

En 10204 - 3.1

INSTALLATION

Vacuum breaker is to be installed in vertical position with the cap at the top with arrow mark shown on body from downward to upward

(SLVB - 76) VACUUM BREAKER

EXPLODED VIEW

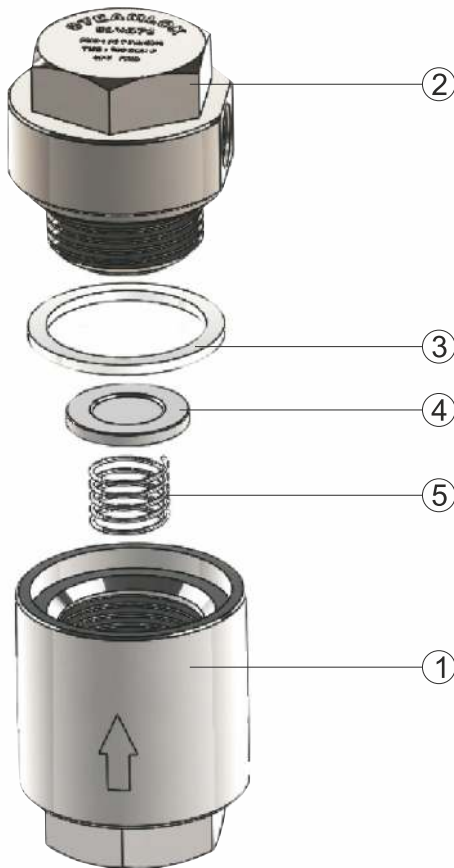

DIMENSIONAL VIEW

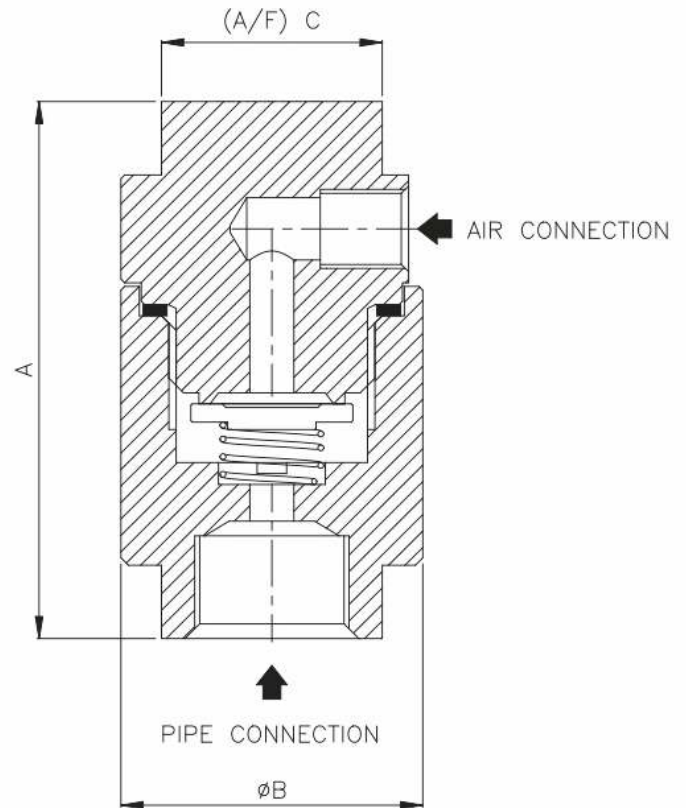

PART LIST

No.	DESCRIPTION	MATERIAL	QTY.
1	BODY	AISI 304	1
2	CAP	AISI 304	1
3	CAP GASKET	GRAPHITE WITH AISI 304	1
4	DISC	AISI 316	1
5	SPRING	AISI 316	1

DIMENSIONAL TABLE

SLVB-76	A (mm)	B (mm)	(A/F) C (mm)	WT.(Approx) (Kg)
15x6 NB	73	41	30	0.580

HOW TO ORDER

Ex. SLVB76, Vacuum Breaker
15NB, Screwed BSPT, Non IBR.

SPARE PARTS

Cap gasket - Set of 5 nos.



Steamlok Engineering Private Limited

Factory : W75, S-Block, MIDC Bhosari, Pune (MH) 411 026, India

Email : sales@steamlokengineering.com

Web : www.steamlok.com | www.steamlok.co.in